

標準濕式多板煞車器 Wet Multi-plate Brake

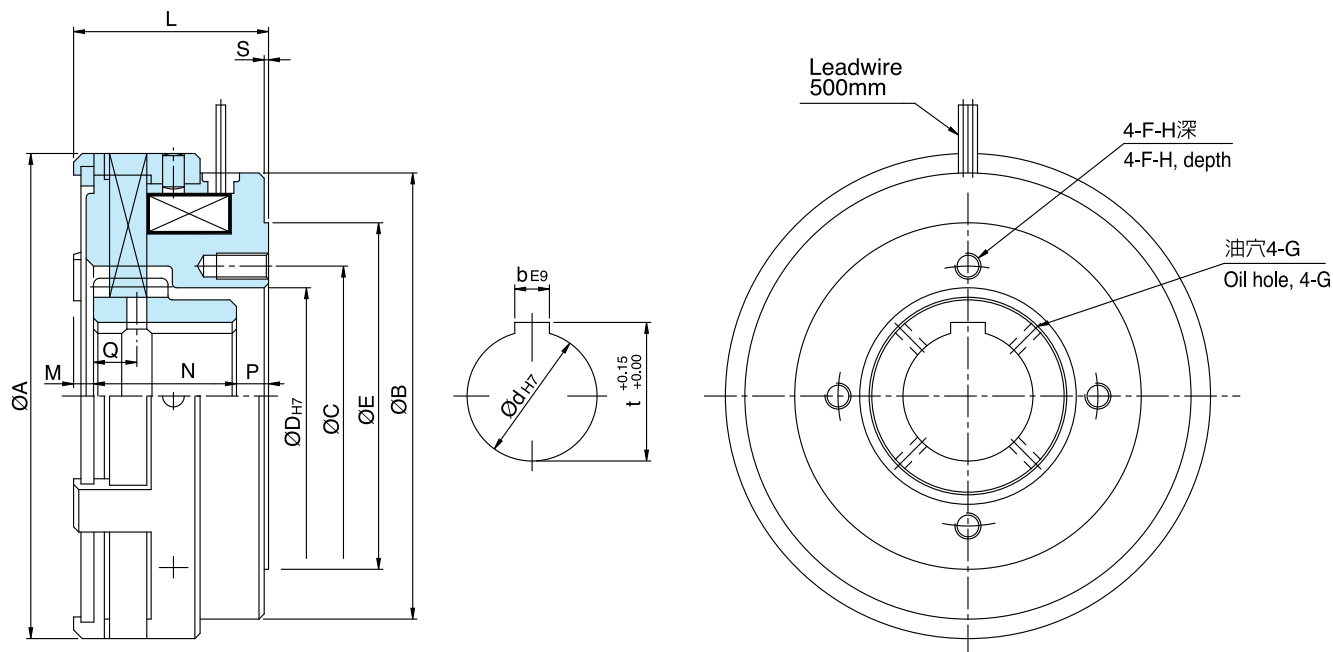

型號 MODEL		MWI1S2AA	MWI2S5AA	MWI005AA	MWI010AA	MWI020AA
靜摩擦轉距 Static Friction Torque [kgm](Nm)		2.5 (25)	5.0 (50)	10 (100)	20 (200)	40 (400)
動摩擦轉距 Dynamic Friction Torque [kgm](Nm)		1.2 (12)	2.5 (25)	5.0 (50)	10 (100)	20 (200)
功率 Power [24V](W) at 20°C		8	12	18	24	28
徑 方 向 Radius	A	80	95	112	132	157
	B	73	87	103	122	148
	C	42	50	60	70	95
	D	32	40	50	56	74
	E	-	-	80	95	116
	F	M5*0.8P	M6*1P		M8*1.25P	M10*1.5P
	G	2	3			
	H	8	12			20
軸 方 向 Shaft	L	30	37	45	52	61
	M	3.5	4	3	4	7.8
	N	23	27	33	35	48
	P	3.5	6	9	13	5.2
	Q	7	8.5	10	13	6
	S	-	-	1		3
	d	20	25	30	40	52
	b	6	8		12	15
	t	21.7	26.7	32	42.5	57
重量 Weight (kg)		0.7	1.3	2.0	3.3	4.5
保護素子 Protective band		GD80KD10		GD80KD14		